

ERGO REVRADIO HANDSET Battery Replacement Guide

© 2012 www.szikla.com



Check Battery Level

Press Forward or Reverse Button.

LED should glow Green or Red, indicating Good Battery Level.

IF LED GLOWS DO NOT REPLACE BATTERY.

If LED fails to glow then Battery needs to be replaced.

This will only happen about once a year, and more frequent replacing of Batteries is not recommended.

UNIT WILL OPERATE 100% RELIABLY FOR SEVERAL WEEKS AFTER LED FAILS.

...so really dudes, take a chill pill and get your hand off the screwdriver.

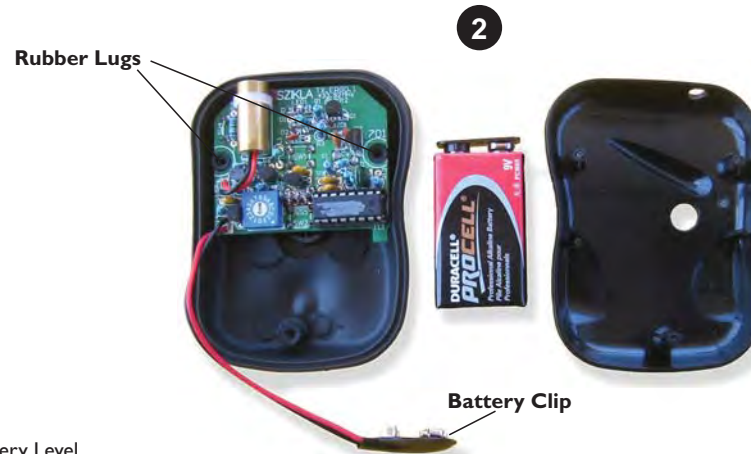

If Battery Change is Indicated

Remove Back Cover and get a fresh Battery.

Alkaline 9 Volt PP3 type is recommended.

Make sure Circuit Board is seated securely around Rubber Lugs.



Connect Battery to Battery Clip

Take note of position of Tab on Circuit Board.

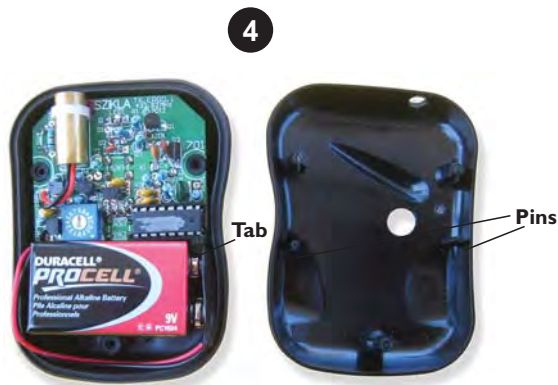

Position Battery against lower edge of Circuit Board

Make sure that the Tab on the Circuit Board ends up between the Battery and the Battery Clip.

Take note of position of Pins in Back Panel.



Replace Back Panel

Make sure the Pins inside make contact with the Circuit Board but do not squash the Battery Leads.

Tighten the 3 Philips Head Screws, but do not overtighten.



Turn Unit Over

Check that buttons operate freely. If not, then repeat steps 4 & 5. Otherwise, unit should now be ready for use.